

WEST JORDAN CITY COMMUNITY DEVELOPMENT

REVIEW CHECKLIST FOR RESIDENTIAL SITE PLANS

In order to better serve the builders developing in the City of West Jordan, the City will be requiring all residential building permits to submit site plans with the following format along with the completed checklist starting **June 28, 2018**.

PLEASE ADDRESS ALL CHECKED ITEMS

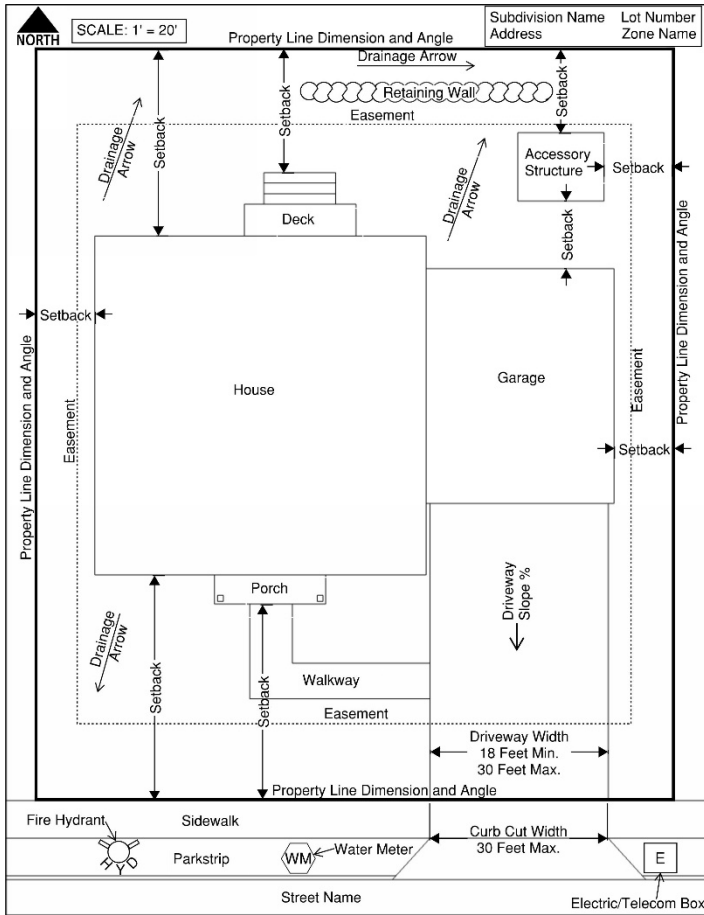

1. Property lines - Show and label with the correct dimensions and angles to match the subdivision plat.
2. Building outline (footprint)
3. Accessory structures outline (footprint).
4. Driveway width, with dimensions.
Minimum width = 18 feet
Maximum width at the back of sidewalk = 30 feet.
5. Curb cut width (approach), with dimensions.
Maximum width = 30 feet.
6. Decks, porches, bay windows, balconies, fireplaces, covered patios, stairwells, cantilevered rooms, etc.
7. Setbacks - show all setback measurements from property lines to the closest point of the structure(s).
8. Easements, as specified on the subdivision plat.
9. Sidewalk, walkways, driveways & RV pads.
10. Driveway slope, if greater than 2%.
11. Grading Features – swales, retaining walls, etc.
12. Drainage arrows – Must coincide with grading plan.
13. Grading Plan - provide a copy of the approved subdivision drainage plan for this lot.
14. Swales/Berms - show cross-section details of swales or berms required by the drainage plan or plat.
15. Water meter, electrical/telecom box and fire hydrants.
16. Street name(s).
17. North arrow.
18. Title block on the site plan shall include the following:
 - Applicable Zoning District
 - Address
 - Lot Number
 - Subdivision Name (if applicable)

drawn to scale showing setbacks, correct dimensions, and house size on paper using an engineer's scale of no less than 1 inch = 20 ft. The submitted site plan shall be on no less than 8 1/2 X 11 sheet of paper.

